

FOR LEASE > ±42,750 SF CLASS A WAREHOUSE BUILDING
(DIVISIBLE TO ±16,894 SF & ±25,856 SF)



Polvorosa Business Park

2265 POLVOROSA AVENUE | SAN LEANDRO, CA



Polvorosa Business Park is designed for office, sales & service, R&D and light industrial tenants. Its unparalleled amenities and beautifully landscaped setting provide a professional environment for today's business. Located in San Leandro with immediate access to Interstate 880 and the Oakland International Airport, Polvorosa Business Park provides a direct link to key commercial and industrial centers throughout the entire Bay Area. It is less than 30 minutes to either San Francisco, San Jose, or the Tri-Valley.

Contact Us

JOE YAMIN
+1 510 433 5812
joe.yamin@colliers.com
CA License No. 01327666



FOR LEASE > ±42,750 SF CLASS A WAREHOUSE BUILDING
(DIVISIBLE TO ±16,894 SF & ±25,856 SF)

Polvorosa Business Park

2265 POLVOROSA AVENUE | SAN LEANDRO, CA

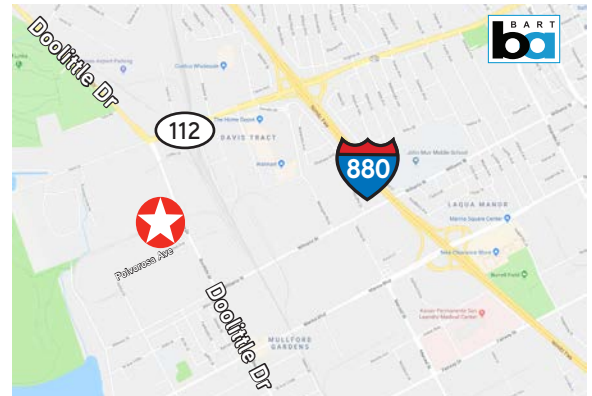
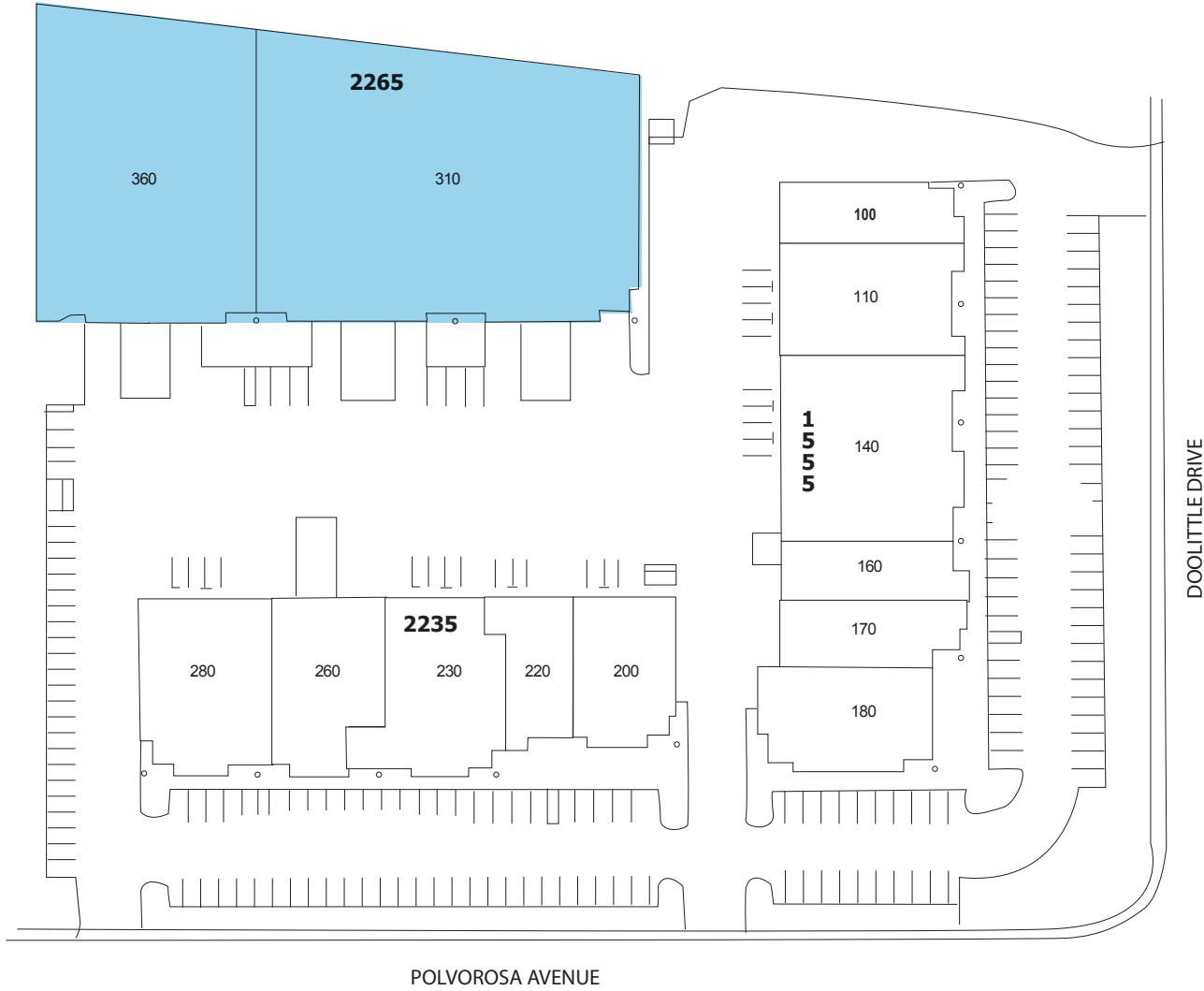

Copyright © 2018 Colliers International. Information herein has been obtained from sources deemed reliable, however its accuracy cannot be guaranteed. The user is required to conduct their own due diligence and verification.

JOE YAMIN
+1 510 433 5812
joe.yamin@colliers.com
CA License No. 01327666



3825 Hopyard Road, Suite 195
Pleasanton, CA 94588
+1 925 463 2300
www.colliers.com/pleasanton

FOR LEASE > ±42,750 SF CLASS A WAREHOUSE BUILDING
(DIVISIBLE TO ±16,894 SF & ±25,856 SF)

Polvorosa Business Park

2265 POLVOROSA AVENUE | SAN LEANDRO, CA

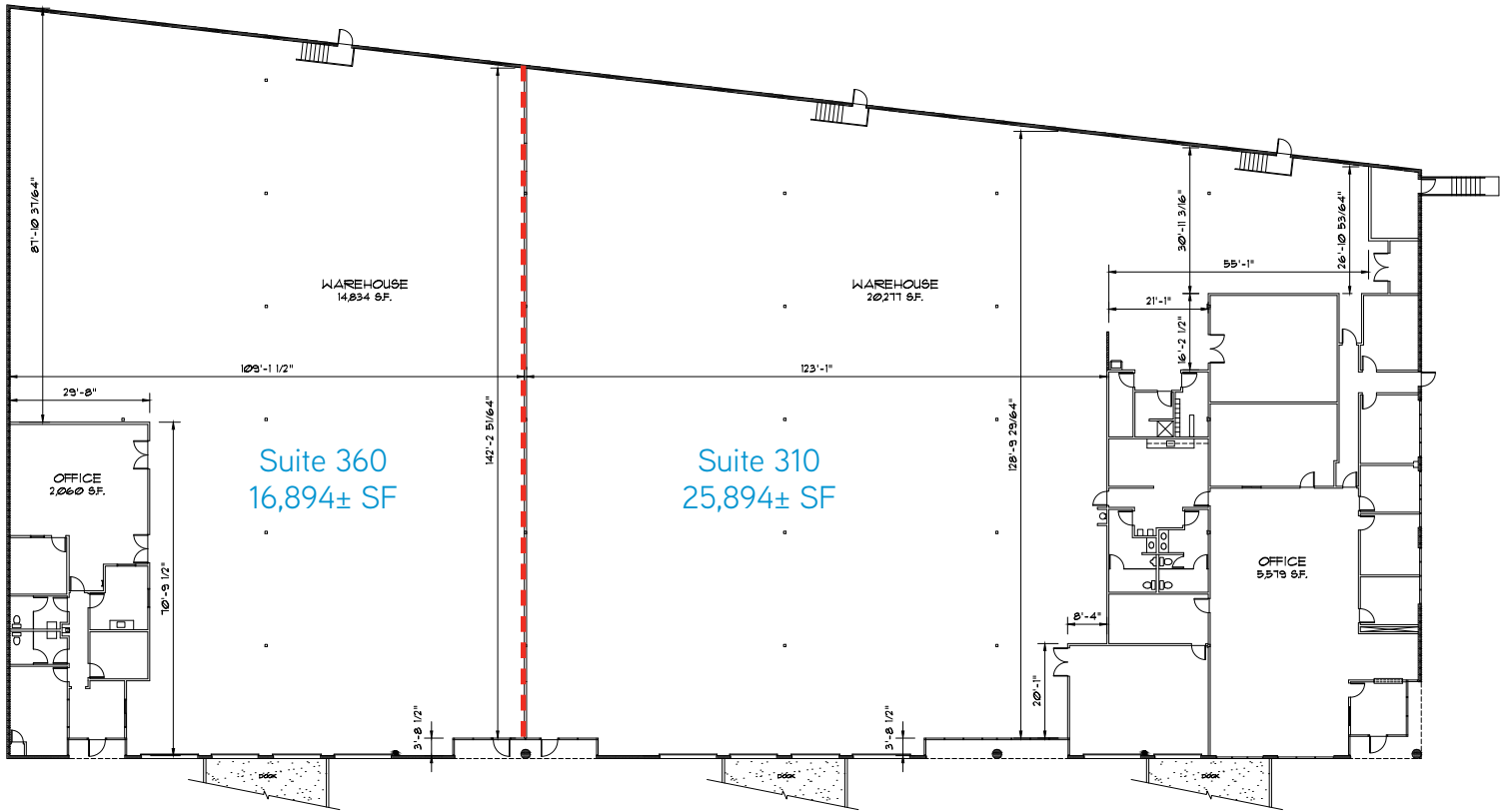

Property Description

- > Total: 42,750 SF
- > Divisible to 16,894 SF & 25,856 SF
- > Warehouse: 35,111 SF
- > Office: 7,639 SF
- > Loading: 5 loading docks & 5 grade level doors
- > Clear Height: 22'-26'
- > Heavy Power: 2,000 amps @ 480v 3 phase
(please confirm with electrician)

Rent: \$0.85/SF/month NNN

(Expenses are currently estimated at \$0.25/SF/month)

Suite 360

- > Total: 16,894 SF
- > Warehouse: 14,834 SF
- > Office: 2,060 SF
- > Loading: 2 loading docks & 2 grade level doors
- > Heavy Power: 1,200 amps @ 480v 3 phase

Suite 310

- > Total: 25,894 SF
- > Warehouse: 20,277 SF
- > Office: 5,579 SF
- > Loading: 3 loading docks & 3 grade level doors
- > Heavy Power: 800 amps @ 480v 3 phase

Copyright © 2018 Colliers International. Information herein has been obtained from sources deemed reliable, however its accuracy cannot be guaranteed. The user is required to conduct their own due diligence and verification.

JOE YAMIN
+1 510 433 5812
joe.yamin@colliers.com
CA License No. 01327666



3825 Hopyard Road, Suite 195
Pleasanton, CA 94588
+1 925 463 2300
www.colliers.com/pleasanton